

MILCOPEX 2016

Crowne Plaza, Milwaukee Airport, Wisconsin

September 16 – 17 – 18 , 2016

**Stamp Exhibition and Bourse of the
MILWAUKEE PHILATELIC SOCIETY, INC.**

Organized Nov. 5, 1899 – 117 Years of Philately in Milwaukee

MILCOPEX 2016, hosted by the Milwaukee Philatelic Society, will be held in the spacious Concorde Ballroom of the Crowne Plaza Milwaukee Airport at 6401 S. 13th St, Milwaukee, Wisconsin. MILCOPEX is returning for our third year at this recently renovated contemporary hotel. Conveniently located just off I-94, and minutes from General Mitchell International Airport, the hotel offers free airport shuttle service and ground level parking. The show site is located only 10 minutes from downtown Milwaukee and just over an hour from the Chicago suburbs. There is a nominal admission charge of two dollars on Friday and Saturday, with FREE admission on Sunday. We are expanding our advertising for the event again this year, in order to set another attendance record!

MILCOPEX 2016 is an APS World Series of Philately show and will feature extensive exhibit space, as well as meeting room space for France and Colonies Philatelic Society, the visiting society for the 2016 show.

Show attendees enjoy easy access to area attractions; including the Milwaukee Art Museum, Milwaukee County Zoo, and the Harley Davidson Museum. Miller Brewery Tours and Miller Park where you can enjoy Milwaukee Brewer's baseball are also just minutes from the hotel's property.

Attached you will find the MILCOPEX rules, show layout, booth pricing, and contract information. We look forward to you to being a part of this event.

Respectfully,

Michael Mules

Michael Mules - MILCOPEX 2016 Bourse Chairman

(414) 234-9867

pnc5dealer@gmail.com

MILCOPEX 2016

**Stamp Exhibition and Bourse of the
MILWAUKEE PHILATELIC SOCIETY, INC.
Organized Nov. 5, 1899 – 117 Years of Philately in Milwaukee**

The Milwaukee Philatelic Society, Inc. will host MILCOPEX on September 16, 17, and 18, 2015, in the spacious Concorde Ballroom at Crowne Plaza Hotel - Milwaukee Airport, 6401 S. 13th St, Milwaukee, WI 53221. Conveniently located just off I-94, and minutes from General Mitchell International Airport, the hotel offers free airport shuttle service, and ground level parking. The show site is located only 10 minutes from downtown Milwaukee and just over an hour from the Chicago suburbs.

MILCOPEX 2016 is an APS World Series of Philately show.

The Milwaukee Philatelic Society, Inc. will exercise reasonable care for the protection of the dealer, his representative and his merchandise. Non-show hour security will be provided; however the officers and members of the Milwaukee Philatelic Society, the MILCOPEX 2016 Committee, and Crowne Plaza Hotel Milwaukee Airport will not be responsible for any losses related to or incurred during MILCOPEX.

Dealers may set up on Thursday September 16th from 3:00 PM until 9:00 PM, and again on Friday September 17th from 7:00 AM until 10:00 AM at which time the show will open. 115 volt electricity will be available for an additional charge of \$30.00 per dealer. If electricity is required please indicate that on your dealer application form.

Your signature on the enclosed application signifies that you accept all MILCOPEX 2016 rules and will abide by them. The application together with payment should be mailed to the Bourse Chairman. Please keep this sheet for your records. An acceptance notice confirming your table assignment will be mailed promptly after your application and payment are received.

MILCOPEX 2016 RULES

No sales are permitted outside of the confines of your table. Merchandise, catalogs, literature, etc. may not be distributed outside of your booth area. This material, with the approval of the Bourse Chairman, may be placed on the Milwaukee Philatelic Society literature tables in the hallway at the entrance of the show. Literature on those tables will be restricted to booth holders at MILCOPEX and for upcoming bourses.

No dealer may sublet part of his/her table(s). Dealers must clear the area and remove all trash and debris on Sunday September 18th, 2016, no later than 6:30 PM

In the event a dealer cannot attend MILCOPEX 2016 as scheduled, the dealer must notify the Bourse Chairman as soon as possible. No refunds will be given unless a replacement can be found. No refund will be given for tables cancelled less than 60 days prior to MILCOPEX 2016.

Dealers must check in with the Bourse Chairman at the time of set up.

Applications received, with \$200 deposit and approved by the Bourse Chairman, will secure booth. Acceptance will be promptly acknowledged. See application for details. Dealers will be required to pay any balance remaining at time of set up.

APPLICATION FOR DEALER TABLE(S)
MILCOPEX 2016 EXHIBITION & BOURSE
Crowne Plaza Hotel Milwaukee Airport
6401 S 13th St
Milwaukee, WI 53221

Friday September 16, 2016 10:00 AM – 5:00 PM
Saturday September 17, 2016 10:00 AM – 5:00 PM
Sunday September 18, 2016 10:00 AM – 3:00 PM

Name (Please PRINT or TYPE): _____ Date: _____

Name of Stamp Business: _____ Phone: _____

Email Address _____ Website Address _____

Street Address _____

City: _____ State: _____ Zip Code _____

Signature (in ink) _____

For our advertising – what items do you carry: _____

Please use the accompanying floor plan and price list and make your 1st choice and alternate selections

1st choice _____ 2nd choice _____ 3rd choice _____ 4th choice _____

Total amount of Table Rent DUE (Minimum deposit required \$200) _____

Electrical Required? (\$30 charge) circle ONE YES NO

Deposit/Payment Enclosed: _____ Balance DUE AT SETUP: _____

Special Instructions or Requirements _____

Make checks payable to: MILWAUKEE PHILATELIC SOCIETY

MAILING ADDRESS - Michael Mules, P. O. Box 6, Salem, WI 53168-0006
Telephone - (414) 234-9867 Fax (586) 563-2849

Applications will be honored on a first come, first served basis. We reserve the right to select those dealers that in our opinion best serve the interests of the Milwaukee Philatelic Society.

Milcopex 2016 Pricing Crowne Plaza, Milwaukee Airport September 16-18, 2016

SINGLE BOOTHS

COLOR	ARRANGEMENT	BOOTH NUMBER AND PRICE
PINK	SINGLE BOOTH 1 FRONT TABLE 1 BACK TABLE	Booths 8, 14, 19 - \$300 each Booths 24, 30 34 - \$250 each
ORANGE	WALL SINGLE BOOTH 1 FRONT TABLE 1 BACK TABLE ON WALL	Booth 4 - \$350 Booths 21, 26 - \$300 each Booths 38, 39 - \$250 each
YELLOW	CORNER BOOTH 1 FRONT TABLE 1 BACK TABLE 1 SIDE TABLE	Booths 6, 9, 12, 15, 17, 20 - \$450 each Booths 22, 25, 28, 31, 32, 35 - \$375 each
GREEN	WALL CORNER BOOTH 1 FRONT TABLE 1 BACK TABLE ON WALL 1 SIDE TABLE	Booths 2, 5 - \$450 each Booths 36, 37 - \$400 each

LARGE FORMAT BOOTHS

BLUE	DOUBLE BOOTH 2 FRONT TABLES 2 BACK TABLES	Booths 7, 13, 18 - \$500 Booths 23, 29, 33 - \$450
PURPLE	WALL DOUBLE BOOTH 2 FRONT TABLES 2 BACK TABLES ON WALL	Booths: 3, 10, 11, 16 - \$550 Booth 27 - \$500
GRAY	WALL TRIPLE BOOTH 3 FRONT TABLES 3 BACK TABLES ON WALL	Booth 1 - \$900

***If you would like to purchase more than one adjacent booth, please contact Michael Mules, Bourse Chairman for availability and pricing.
(414) 234-9867 or pnc5dealer@gmail.com**

Milcopex 2016

Crowne Plaza, Milwaukee Airport

September 16-18, 2016

Milwaukee Philatelic Society Welcomes You



Show Entrance

Loading Dock

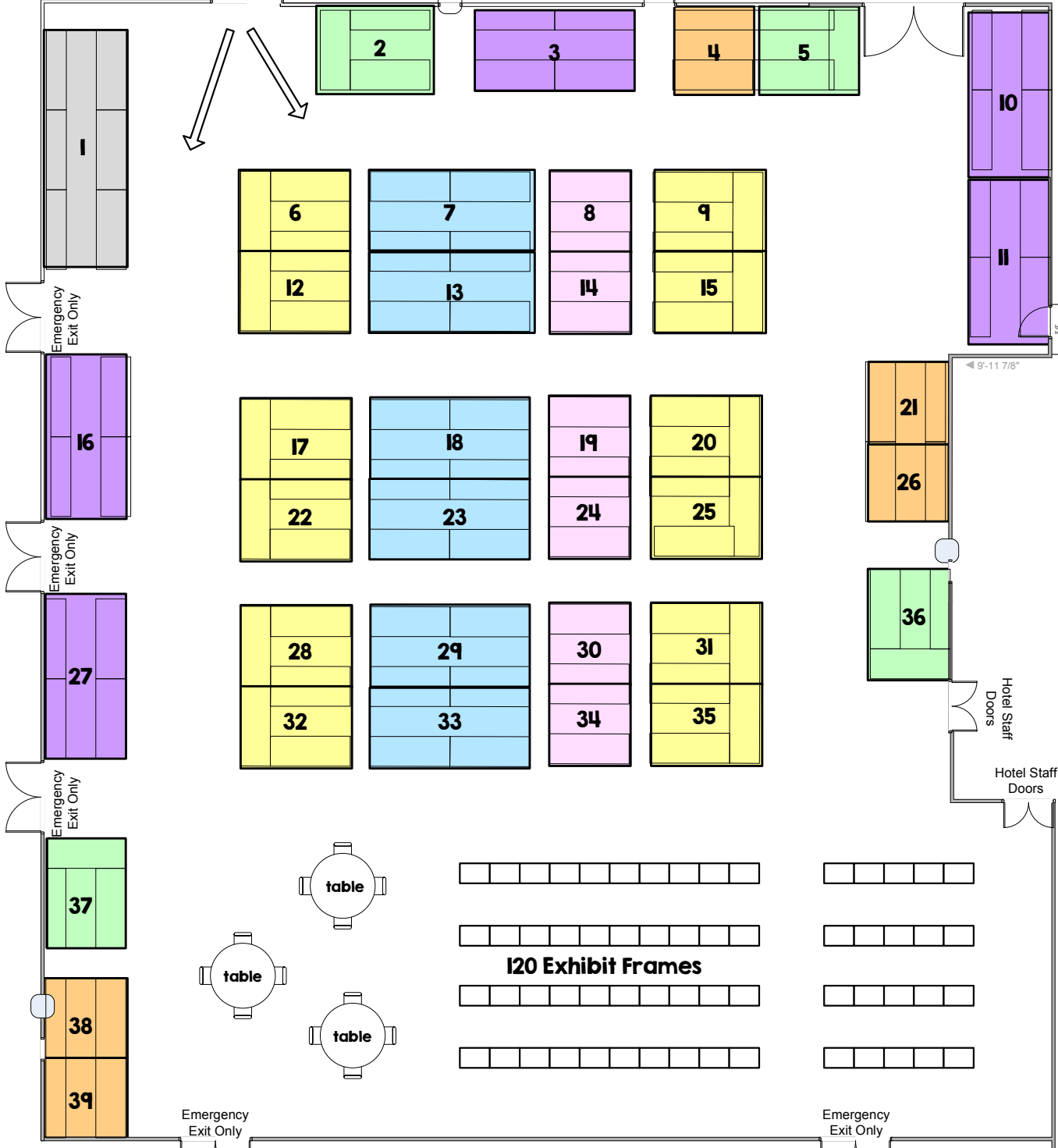
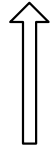

Emergency Exit Only

Emergency Exit Only

Emergency Exit Only

Emergency Exit Only

Hotel Staff Doors

9'-11 7/8"

Hotel Staff Doors

Hotel Staff Doors

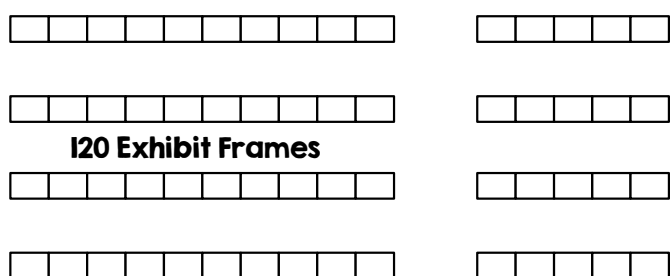
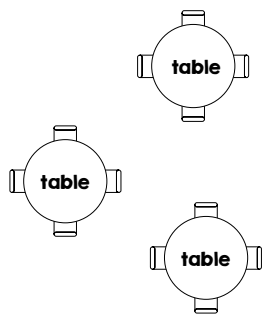

120 Exhibit Frames

Emergency Exit Only

Emergency Exit Only

Hotel Lobby

Restaurant and Banquet Hall

